

MODEL CAL136.302

DISCHARGE TUBE VIBRATION DAMPER KIT

! CAUTION

Disconnect or turn off all electric sources before servicing.

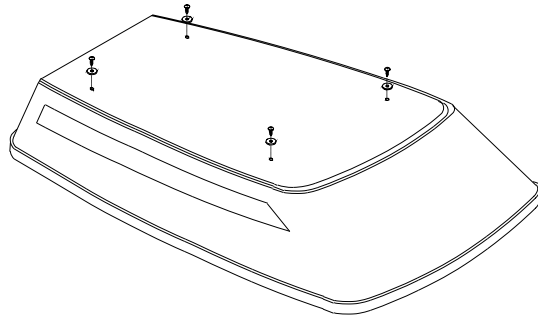

1. Remove outer cover and set aside.

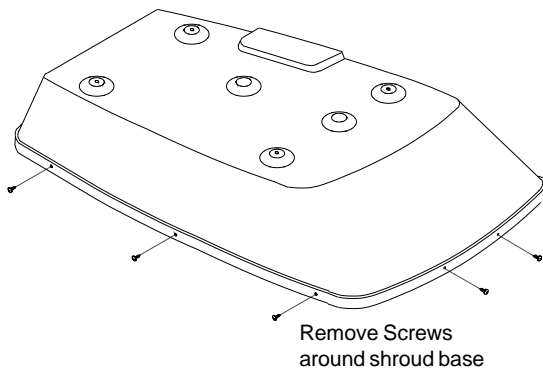

2. Remove screws and set inner cover aside.

3. Wrap a 17-18 cm strip of black thermal mastic around the discharge tube next to the downward bend.

4. Reassemble both shrouds.

6. Reconnect the power.

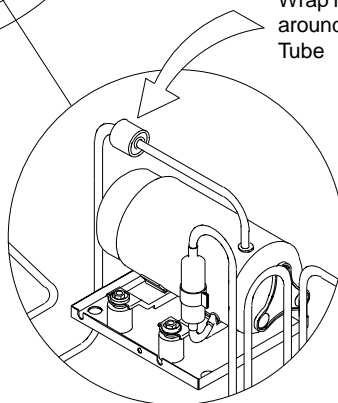
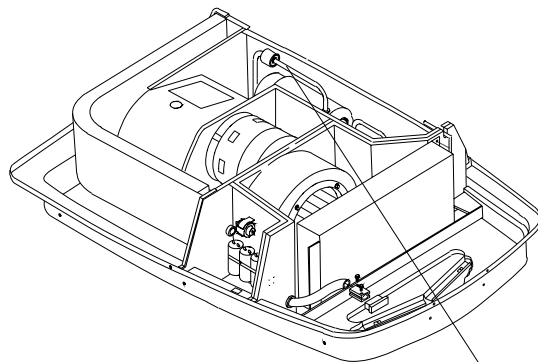

CAL 136.302

