

USA
SERVICE OFFICE
The Dometic Corp.
509 So. Poplar St.
LaGrange, IN 46761

CANADA
Dometic Dist.
866 Langs Dr.
Cambridge, Ontario
CANADA N3H 2N7

**Fabric Roller Tube Assembly
with "Nested" Universal Hardware**

**INSTALLATION
INSTRUCTIONS**

**MODEL
8300**

INSTALLATION

COVERED BY PATENT 4,524,791
OTHER PATENTS APPLIED FOR

REQUIRED PARTS (Packed with each Hardware Assembly)

- (2) 1/4–20 Phillips Machine Screws
- (2) 1/4–20 Locknuts
- (2) Nylon Washers
- (4) #14 x 2 Screws
- (4) #14 x 3 Screws
- (2) #10 Machine Screws
- (2) #10 Locknuts
- (2) Stop Washers
- (2) #6 Self-Drilling Screws
- (1) **Door Roller Kit, Containing:**
 - (2) #10 Self-Drilling Screws
 - (1) Door Roller
 - (1) Edge Guard

Application

The A&E Awning is designed and intended for use on motorhomes, mini-motorhomes, 5th wheels and travel trailers with straight sides.

IMPORTANT: Read ALL of the following steps before beginning installation.

The Dometic Corporation reserves the right to modify appearances and specifications without notice.

Installation of A&E Awnings will at some points, require three people. Use the following procedure to assure a properly installed, and properly functioning awning.

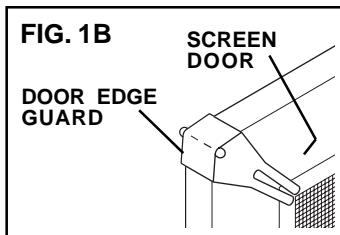
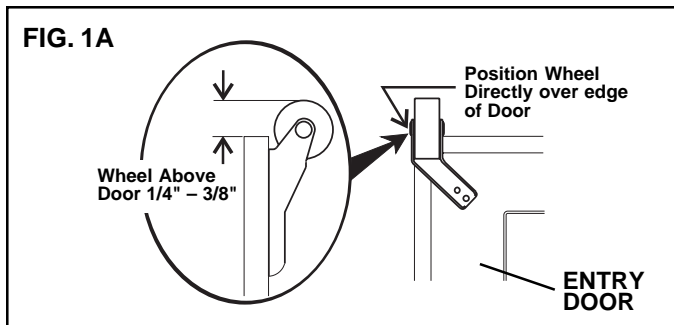

1. Where the A&E Awning is to be mounted above the entry door, the door roller must be installed on the exterior side of the door in the extreme upper corner above the door handle. (FIG. 1A)

In addition, if there is a screen door inside the regular door, a door edge guard must be installed on the exterior side of the screen door, in the extreme upper corner opposite the door hinges. (FIG. 1B)

This allows the door roller or the edge-guard (instead of the sharp door corner) to contact the underside of the fabric when the entry or screen door is swung out while the awning fabric is extended low.

2. Carefully lay the fabric roller tube assembly on a clean, well padded "V" trough to prevent fabric damage. Secure both arm assemblies to the respective torsion rods using the 1/4–20 hex cap screws, nylon washers, and 1/4" locknuts. The right side has the torsion lock lever and the serial number tag. (FIG. 2)

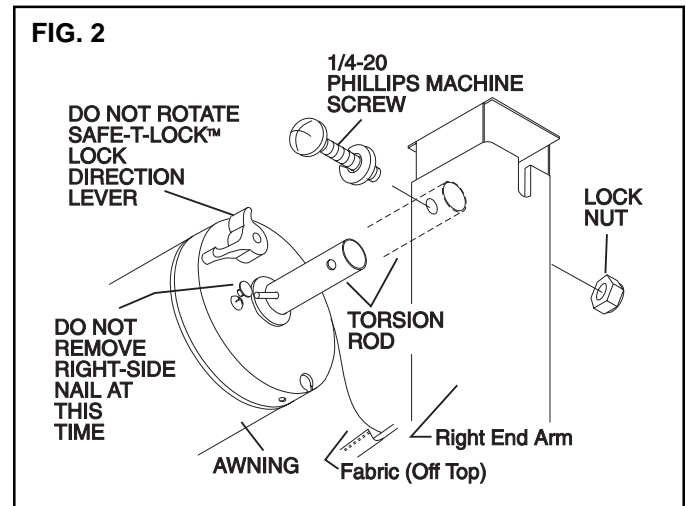

3. Remove the left nail only. With both awning arms secured to the Fabric Roller Tube Assembly, twist the roller tube as if unrolling the fabric, and remove the nail by hand.

! WARNING

DO NOT REMOVE the NAIL from the right end at this time and DO NOT attempt to rotate the Safe-T-Lock™ Lock Direction Lever until installation is complete. (Lever has been preset in the roll-down position.) (FIG. 2)

4. Prepare the awning rail to accept the awning roller cover by selecting the end from which the awning shall be fed, then widen that end of the rail with a flat screwdriver and remove burrs. (FIG. 3)

With one person grasping each support arm, carefully lift the entire assembly to an upright position.

Keeping the two arm assemblies **PARALLEL** to each other to avoid excessive twisting and possible damage to assembly, walk the awning to the prepared end of the awning rail (FIG. 4A)

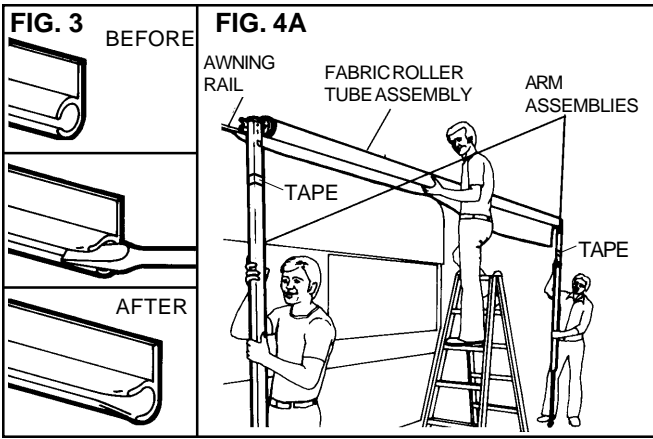

A third person is now required to guide the full awning into the awning rail while standing on a stepladder, while the other two walk the entire awning assembly to the desired position. (FIG. 4)

5. Additional stability can be gained at this point by lifting handle (releasing lock button) on the side of the main arm and CAREFULLY allowing the inside adjustable arm to extend to the ground (FIG. 5D).

6. Install Top Mounting Brackets.

After the complete awning assembly has been slid into the awning rail, check to be sure that its position allows for solid mounting of the top and bottom brackets and that support arms are in desired location (not restricting use of doors, access doors, etc.). (FIG. 5A)

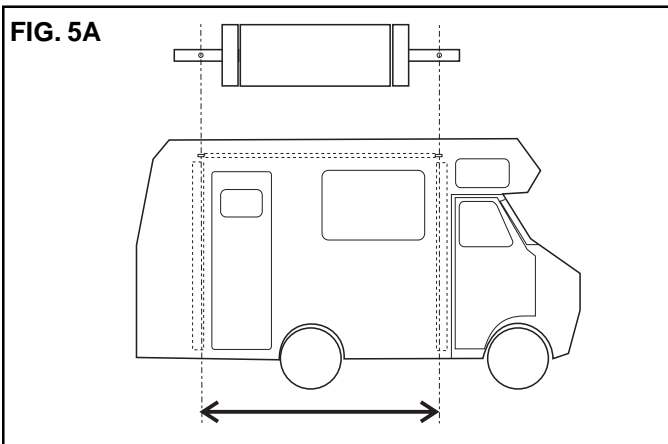

Place top bracket in position over awning rail as shown in FIG. 5B, and align bracket directly behind and centered with the main support arm.

Pull the main support arm away from the top mounting bracket and rafter arm. Mark the top bracket position and predrill the two holes using a 3/16" drill bit. (Use 7/32" drill bit if drilling through steel). Install top bracket with two #14 x 3" hex. hd. screws (FIG. 5C). It is recommended that clear silcon be used to seal the screw where it enters the coach.

Place main support arm over the extension portion of the top bracket. (FIG. 5B).

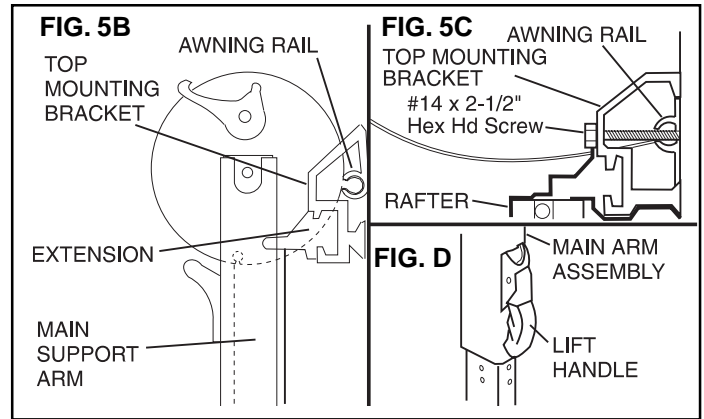

Install remaining top mounting bracket using the same procedure.

7. Installation of Bottom Mounting Brackets.

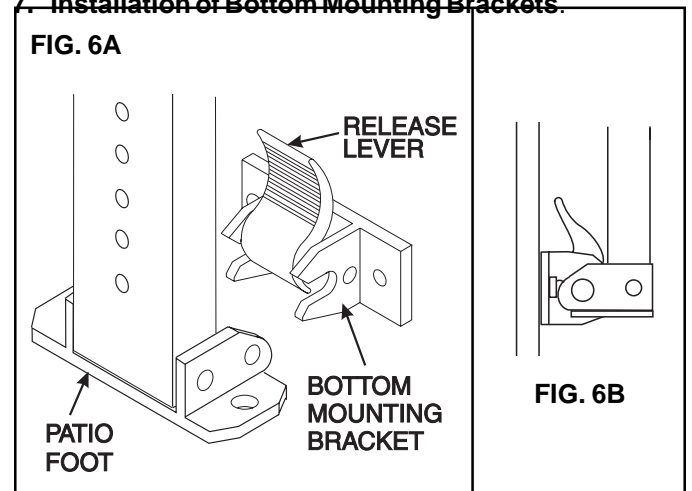

Connect the patio foot located at the bottom of the adjustable arm, to the bottom mounting bracket, guiding the shank portion of the patio foot into its receptacle in the bottom bracket and allow the patio foot to slip into the bracket. (FIGS. 6A & 6B). Release the lock button by lifting the handle on the side of the main arm and slide the adjustable arm up to the desired mounting position. Always select the position that offers the best supporting structure for mounting the bottom bracket, i.e. mounting the bottom bracket directly into the floorline, molding, etc.

Allow the lock button (in handle) to catch one of the pre-punched holes that are spaced 3/4" apart.

Once again, check to be sure that the top portion of the main arm is still temporarily resting over the top bracket. Mark position of bottom bracket so that both holes are positioned over the floorline. Disconnect bottom bracket from patio foot and pre-drill two 3/16" dia. holes through the marked locations. (Use 7/32" dia. if drilling through steel).

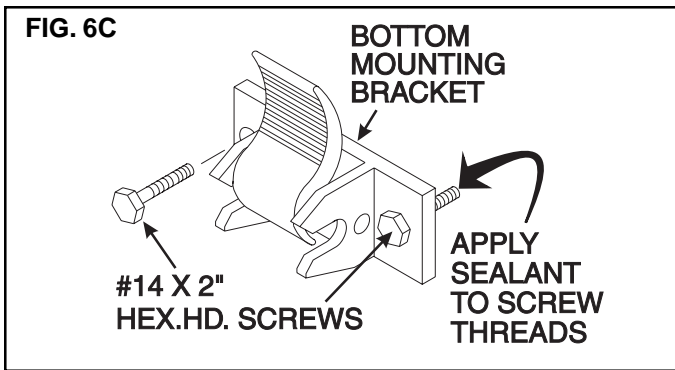

Secure bracket using two #14 x 2" hex head screws. (FIG. 6C). Seal the screw where it enters the coach.

Repeat for other side.

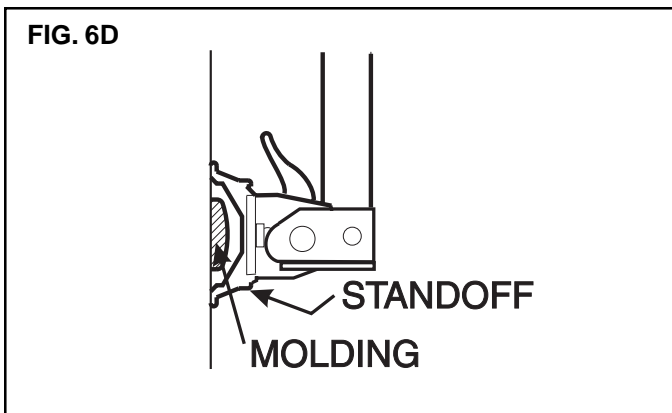

! CAUTION

The bracket **MUST** be mounted level.

If installing over a molding, A&E Standoff Kit 3104781 may be used (See Fig. 6D).

8. Installation of Stop Plugs.

CAUTION: This step is essential for the proper functioning of all A&E Awnings.

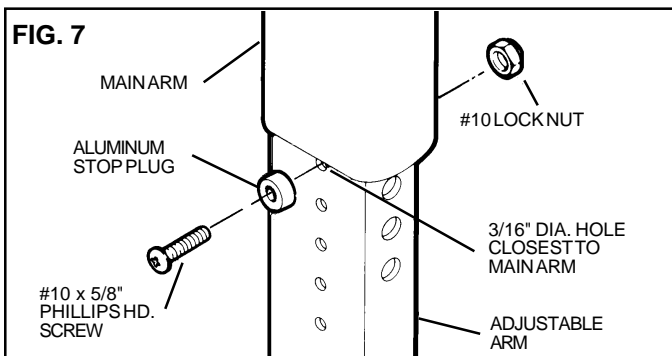

After both bottom brackets are installed, and both main support arms are engaged into pre-punched push button holes on the adjustable arms, depress the push button on one main arm and **RAISE THE MAIN ARM UP BY ONE HOLE ONLY.**

On the front of the adjustable arm, locate the small 3/16" dia. hole which is closest to the bottom of the main arm (FIG. 7). Install aluminum stop plug in this hole by inserting a #10 x 5/8" phillips screw through the stop plug and through the hole. Secure with a #10 lock nut (FIG. 7).

THE MAIN SUPPORT ARM SHOULD NOW COMPLETELY CLEAR THE TOP BRACKET AS IT SWINGS TOWARD THE VEHICLE SIDE.
Repeat for other side.

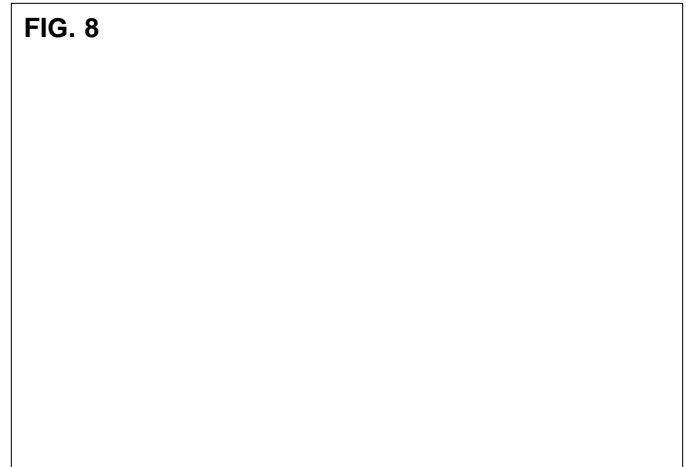

9. Releasing Pre-Set Tension.

! WARNING

When removing nails, keep hands clear of hardware and roller tube. Springs are under tension and the awning will attempt to close.

The nail is found in the roller tube end cap (FIG. 8). Twist the roller tube as if unrolling awning while pulling the nail by hand and discard.

Remove wire tie from the Safe-T-Lock™ Lever. Rotate the lever to the roll up position and allow the awning to roll up. The awning should now roll up snugly against the vehicle side. If no tension is felt, check to make sure the Safe-T-Lock™ Lever is in the roll-up position.

10. Securing Awning

The fabric must be secured from shifting within the awning rail.

Open and close awning a few times to allow for natural self adjustment of awning. Track the strap slightly to one side as it closes to avoid bulging over the extra thickness of material and stretching the fabric.

With the awning closed, the fabric will locate itself between the two top brackets. Pull the fabric sideways 1/4" in the awning rail. Measure in 2" from the edge of the fabric and secure by driving a #6 self-drilling screw through the rail and into the fabric rope. (FIG. 9)

Repeat at the other end, pulling the fabric 1/2" and holding while securing the fabric. This will ensure a wrinkle-free weather shield.

11. Operate awning according to the Operating Instructions to check that all parts function properly.

12. Secure the travel latches.

