



# IN-WALL™ SLIDE-OUT CONTROLLERS

## SLIDE-OUTS

Rev B



Rev C-1



Rev C-2

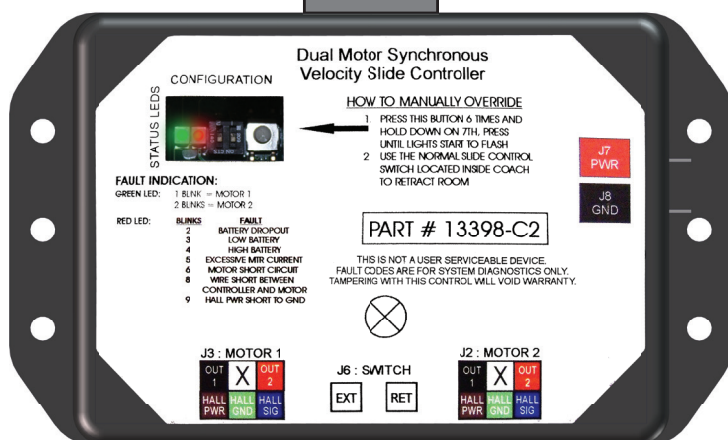

8 Amp

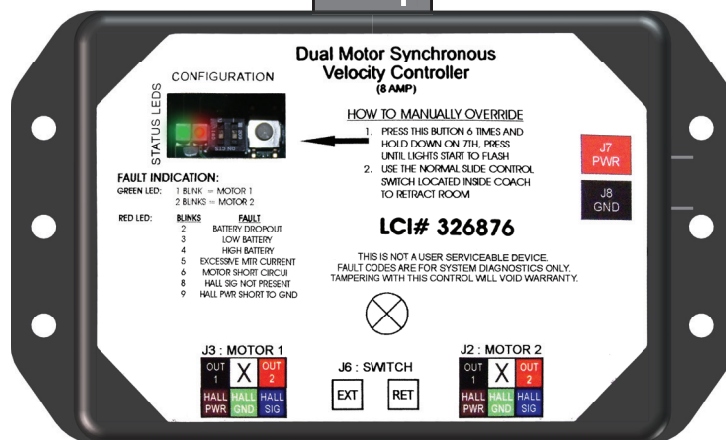

Part #	Description
211852 - Rev B, Rev C-1, Rev C-2	Dual Motor Synchronous Velocity Slide Controller
326876 - 8 amp	Dual Motor Synchronous Velocity Slide Controller <b>NOTE:</b> This controller will not replace other controller versions.



LIPPERT  
COMPONENTS

# IN-WALL™ SLIDE-OUT MOTORS

## SLIDE-OUTS



Callout	Part #	Description
A	229466	Motor
B	287298	Motor, High Torque 500:1
C	236575	Motor, 300:1
D	-	Obsolete (Replace with 236575)



# IN-WALL™ SLIDE-OUT COMPONENTS

## SLIDE-OUTS

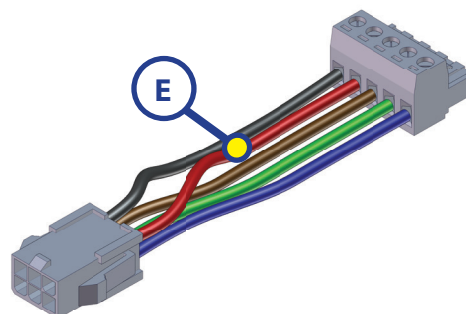
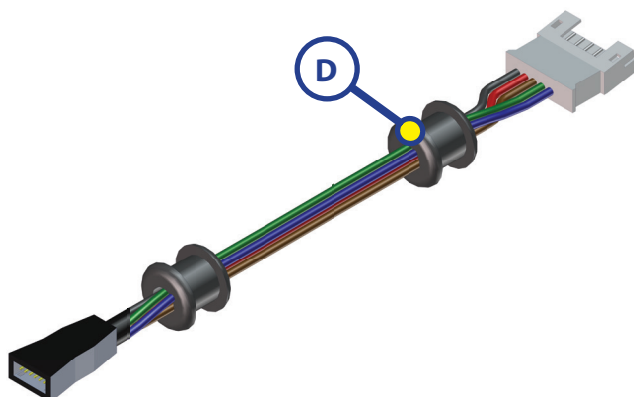
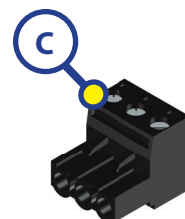
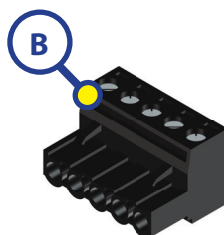
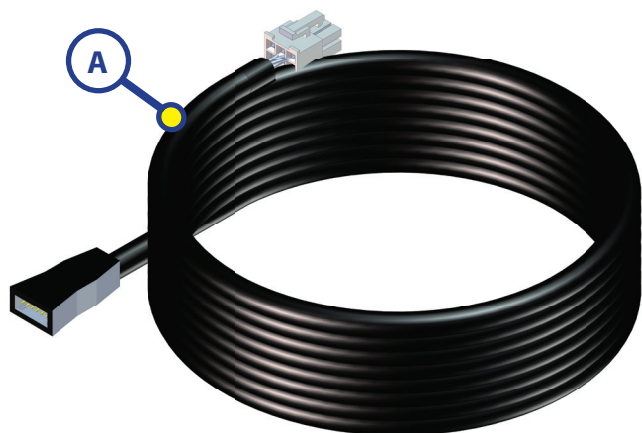

Callout	Part #	Description
A	238744	5 ft. Controller to Motor Harness
	238990	10 ft. Controller to Motor Harness
	247768	15 ft. Controller to Motor Harness
	229755	20 ft. Controller to Motor Harness
	238991	25 ft. Controller to Motor Harness
	229756	30 ft. Controller to Motor Harness
	238992	35 ft. Controller to Motor Harness
B	229758	Harness Connectors 5 Wires
C	229759	Harness Connectors 3 Wires
D	241834	5 ft. Interconnect Harness
	241835	6 ft. Interconnect Harness
	241836	8 ft. Interconnect Harness
E	258760	Slide Controller 6" Pigtail Harness (For use with B and C-1 Controllers with (A) harness)



LIPPERT  
COMPONENTS

# IN-WALL™ SLIDE-OUT COMPONENTS

## SLIDE-OUTS

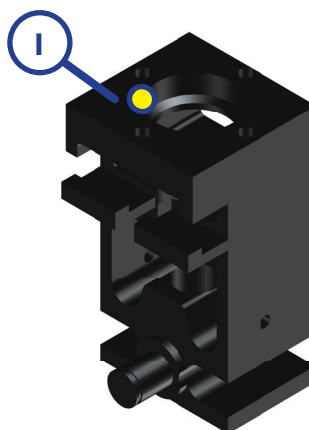
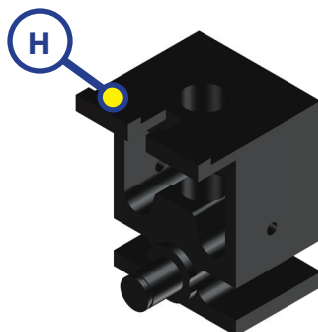
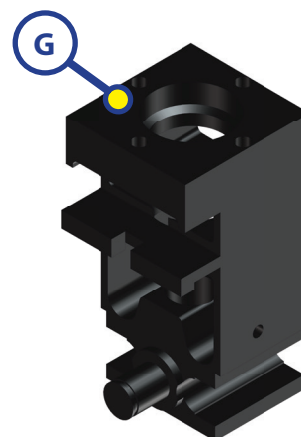
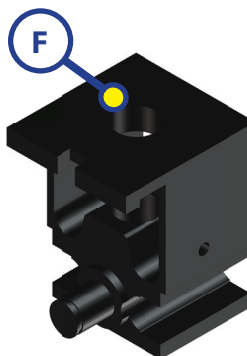
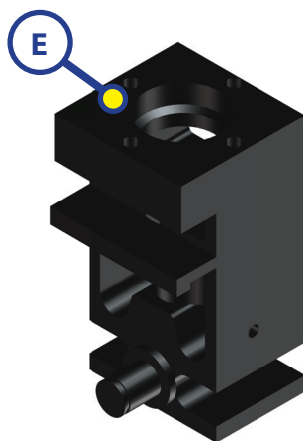
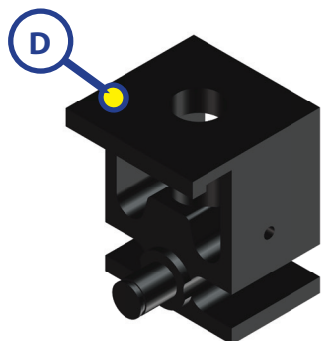
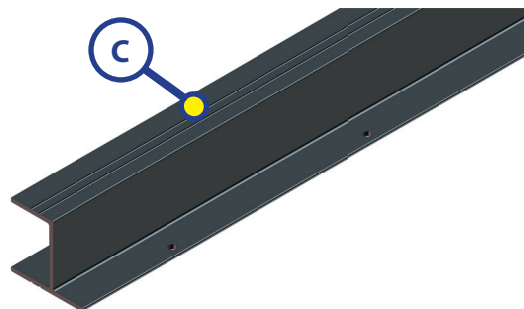
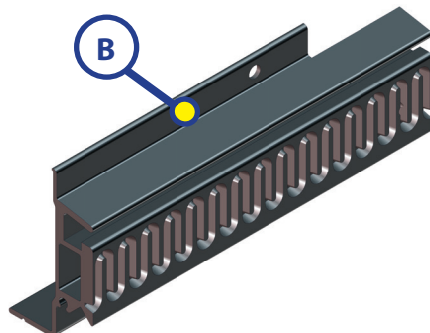
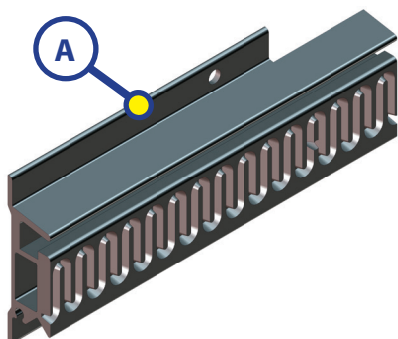

Callout	Part #	Description
A	254569	Upper Gear Rack
B	254570	Lower Gear Rack
C	240411	H-Column, Black
	238457	H-Column, White
D	239365	Lower Bearing Block
E	239366	Upper Bearing Block
F	335632	Lower Bearing Block (Hex Shaft)
G	335633	Upper Bearing Block (Hex Shaft)
H	338237	Lower Bearing Block (Steel Shaft)
I	338241	Upper Bearing Block (Steel Shaft)



## SLIDE-OUTS

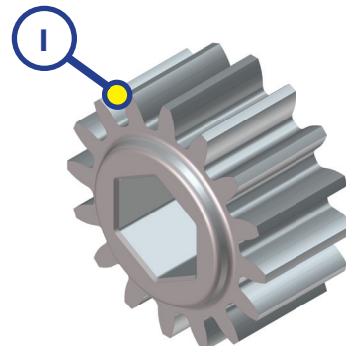
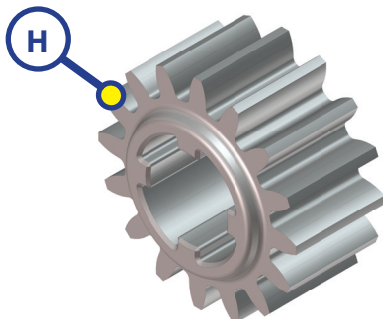
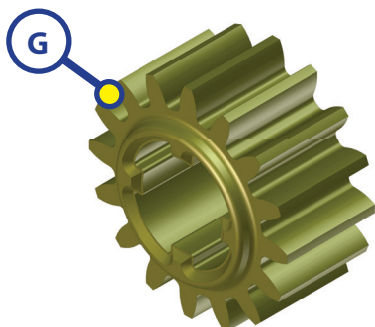
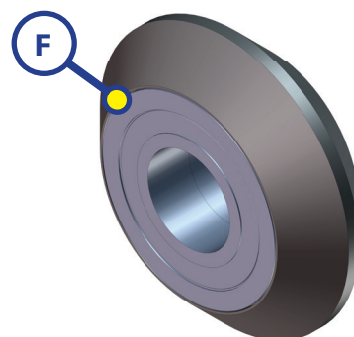
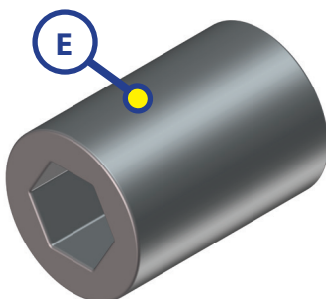
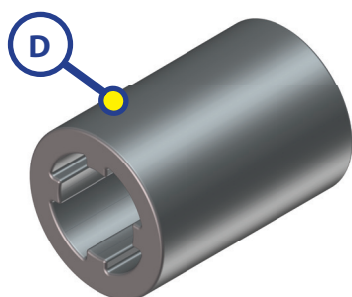
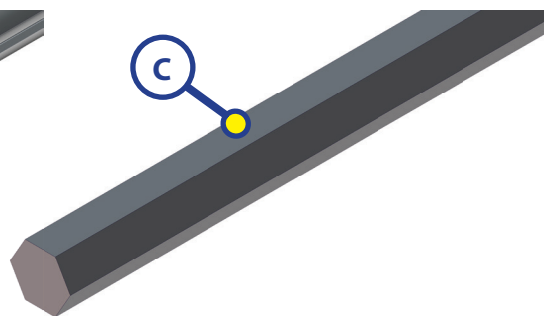
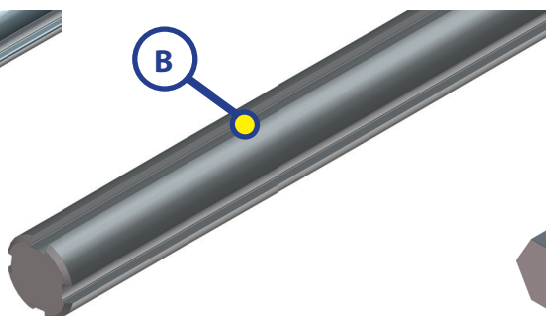
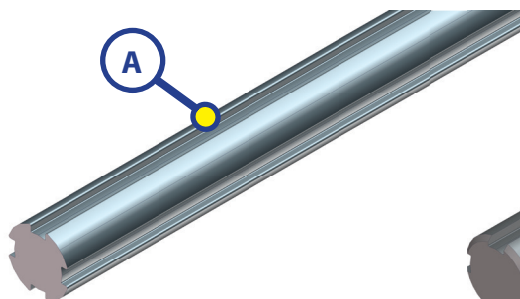

Callout	Part #	Description
A	238462	Aluminum Torque Shaft
B	259065	Steel Torque Shaft
C	295873	Hex Torque Shaft
D	238461	Coupler - Old Style (for 229466 Motor)
	238461	Coupler - New Style (for 236575 Motor)
E	285083	Hex Coupler
F	292801	V-Roller Assembly
G	238893	Spur Gear
H	292435	Copper Infused Spur Gear
I	285085	Hex Spur Gear