

# SuperSlide II PowerSlide Assembly Instructions

## Quantity Description

1	Power module
1	Power module drive channel
4	Limit switches
8	Slide switch spacers
8	Screw BHCS 4-40 x 1"
8	Nut Nylock 4-40
2	5/16"-18 x 1 HH GR.5 bolts
2	5/16-18 Nylock nuts
4	1/4"-20 x 3/4 HH GR.5 bolts
4	1/4 Split lock washers

## Overview

The **SuperSlide II Powerslide Assembly Instructions** are for adding the **power slide module** to an already installed manual slide or an unassembled version of the power slide.

For a fully assembled version, skip to the section titled **Assembly into Coach** beginning on Page 3.

For an unassembled version, begin by following the instructions provided in the kit for the manual slide, which are included in the rail slider kit. Once the manual slide is assembled, use the **SuperSlide II Powerslide Assembly Instructions** to install the power drive option. The power drive option comes fully assembled and requires only the addition of wiring.

## Extension

Begin SuperSlide II PowerSlide assembly by connecting the limit switches to the manual tray. See **Figure 1** for limit switch locations. A total of 4 switches will be placed on the tray.



**Caution should be used when tightening the screws retaining the limit switches to prevent over tightening and fracture of the switch case.**

The switches should be connected to the fixed rail that is on the **front** side of the coach. When the power module is finished, it will be located on the front side of the coach.

Figure 1

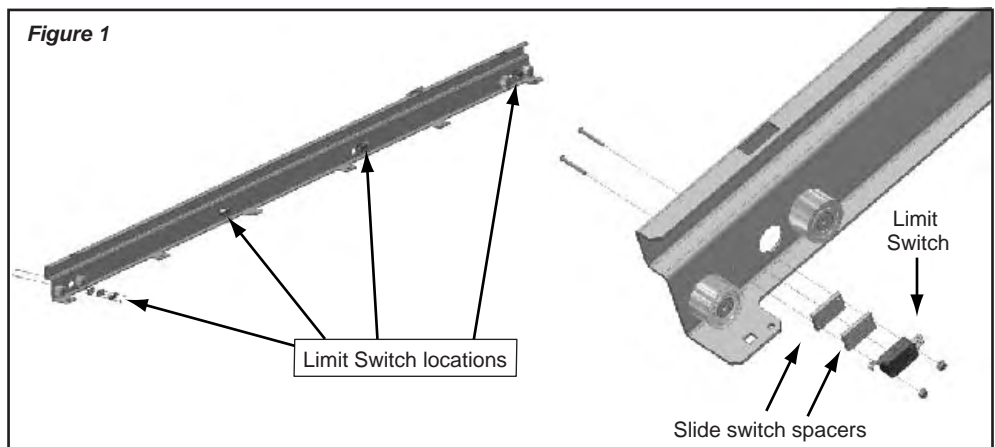

**Kwikkee Products Company, Inc.**  
230 Davidson Avenue  
Cottage Grove, Oregon 97424-9545  
(541) 942-3888  
[www.kwikkee.com](http://www.kwikkee.com)

## Installing the Wiring Harness

After the limit switches are connected, the wiring for the power module should be connected. **Figure 2** shows how the wire harness is routed.

First connect the limit switches to the wiring harness. Locate the short side harness. It is physically shorter in length than the long side of the harness.

Route the short side of the harness toward the passenger side of the tray with the longest pair of spade connectors going to the switch closest to the end on the passenger side as shown in **(Figure 2A)**

The next two spade connectors on the harness connect to the switch on the passenger side which is located as shown in **Figure 2B**.

The long side harness should be routed along the tray toward the driver side.

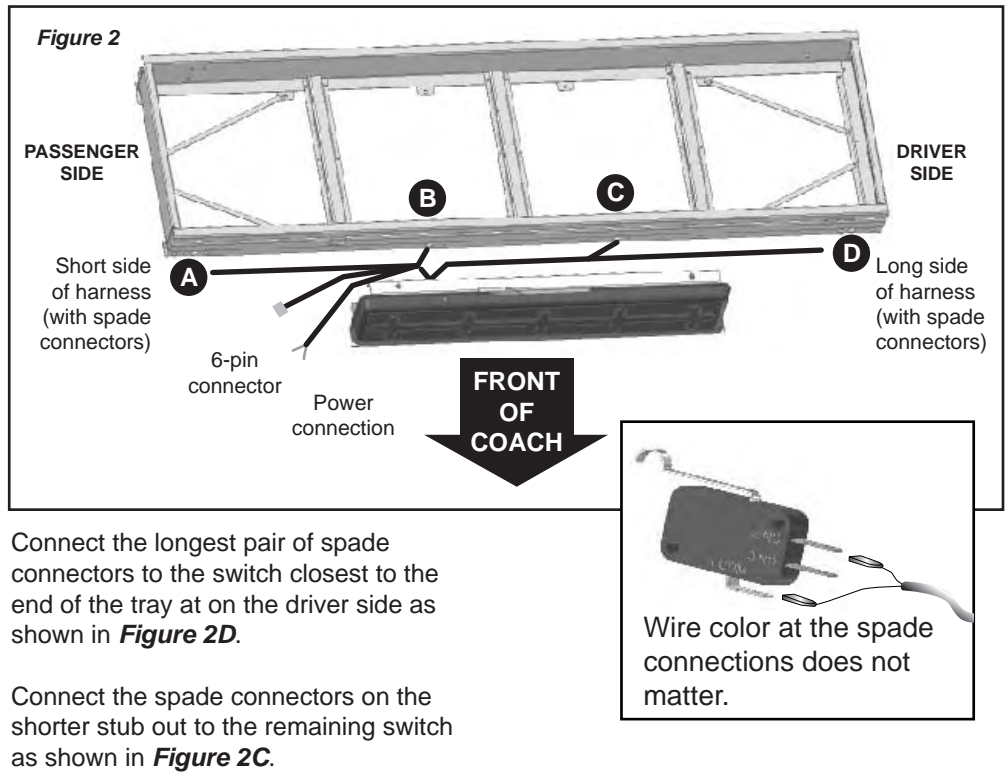

## Attaching Power Module to Fixed Rail Assembly

With the spade connectors attached to limit switches A, B, C, and D, you may bolt the power module to the fixed rail using 4 1/4"-20-UNC bolts (included) and split lock washers as shown in **Figure 3**. A 7/16" socket or box end wrench is required.

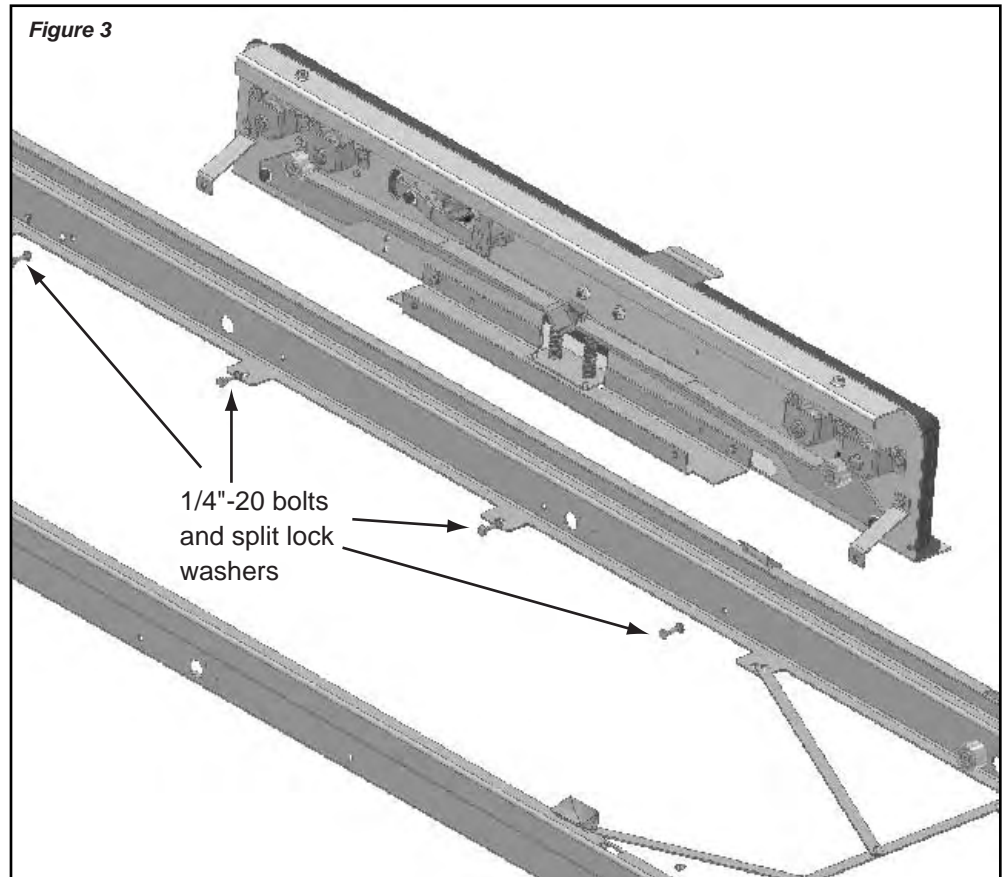

## Assembly into Coach

With the power module assembled (except for the drive channel on the unassembled versions) attach the tray into the coach using 5/16" carriage bolts (not provided).

Connect the cargo bay door switches per the wiring schematic shown to the right.

**Note:** The cargo bay door switches should be of the **Normally Closed** type. In other words, the switch should not have continuity through it when the cargo bay door is closed. The ground signal for the cargo bay switches should be picked up from the 6-pin connector as illustrated in the wiring schematic (shown right).

**TIP:** It is strongly suggested that at least one remote rocker switch be connected as illustrated on the wiring diagram. The switch will provide tray access in the event the RF remote is lost, damaged, or the battery goes dead.

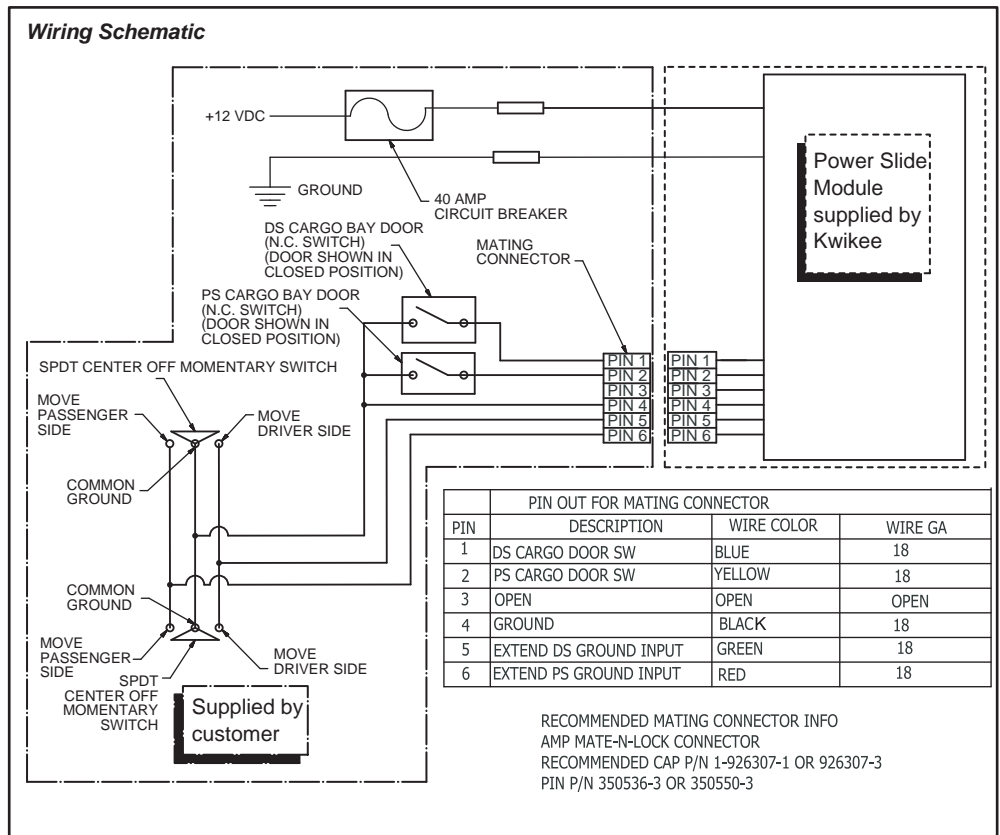

## Installing Power Module

First, move the tray to the center position. If the drive channel has been previously installed, it will be necessary to use the manual release. Rotate the manual release fully as shown in **Figure 4**. Manually push the tray to the center position and let go of the release.

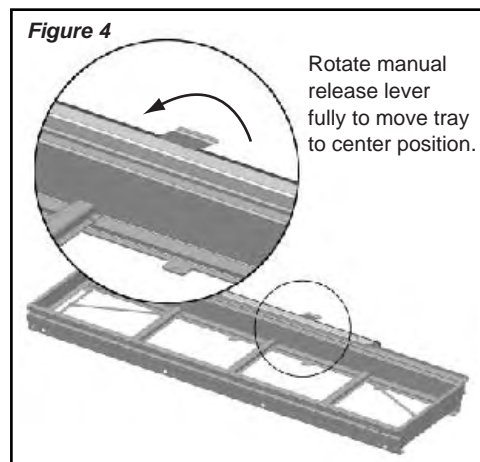

With the tray centered, apply power to the power leads as indicated in the wiring schematic (above, right).

## Programming Remote

To program the power module to the RF remote transmitter, insert the eraser end of a pencil through the hole in the top of the ABS cover on the power slide, as shown in **Figure 5**. The hole is located on the Passenger top side of the cover. With the eraser end of the pencil, press the switch on the top of the control. When pressed, a red LED will start to flash. The LED can be seen through the hole in the cover. Once flashing, select which set of buttons you would like to have correspond to this slide. Press any button on the remote that corresponds to Slide 1 or Slide 2. This will program the slide to that remote setting.

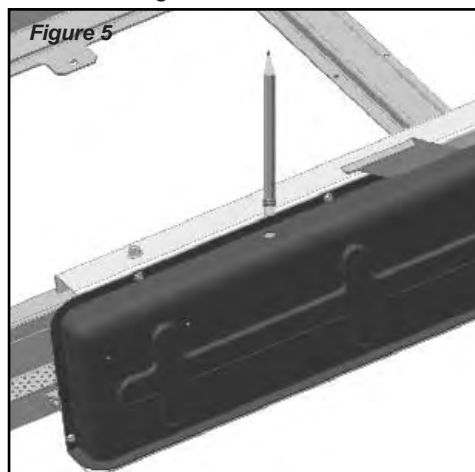

## Insert Drive Channel

Insert the drive channel as illustrated in **Figure 6**. **NOTE:** This may already be completed on some preassembled units.

**!** Make sure both cargo bay doors are open.

Position the end of the channel into the power module on the passenger side. Press the RF remote transmitter to move the channel toward the driver side. When the channel is engaged on both sets of rolls on the power module and protruding about 1 foot to the other side, press and hold the button again to stop the motion of the slide.

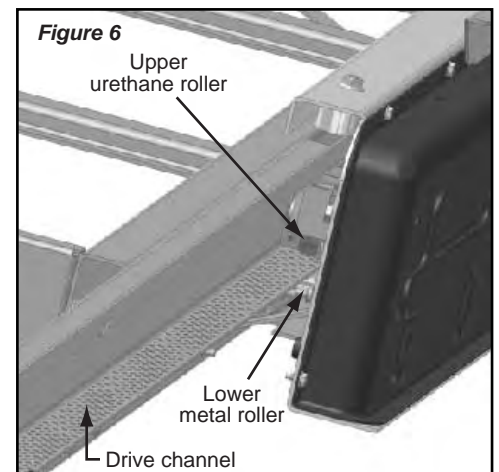

## Completing Assembly

With the drive channel inserted into the power module, the connections can be made at each end, as shown in **Figure 7**. Pull the slide into position to make the connections. When connections are completed, pull the manual release and center the slide (as in **Figure 4**.)

Remove and reconnect power to the slide. This will initialize the slide and allow it to function properly.

**NOTE:** Tighten the nylock nut and bolt, then back off 1/2 turn so that the drive channel has the freedom to move up and down relative to the slide.

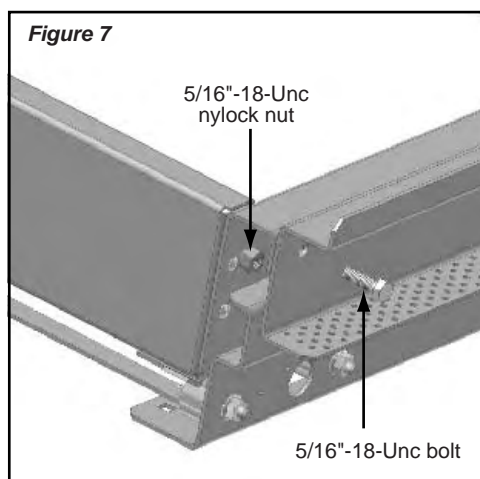

Figure 7

5/16"-18-Unc  
nylock nut

5/16"-18-Unc bolt

For replacement part information or to order additional remotes, visit us on the web at: [www.kwikee.com](http://www.kwikee.com)

## Testing **NOTE: Leave both cargo bay doors open.**

- Press the driver side button and the slide should travel fully outward on the driver side.
- Press the STOW or passenger side button and the slide should travel to the centered position and stop. The lock should engage.
- Press the passenger side button and the slide should travel fully to the passenger side.
- Press the STOW or driver side button and the slide should travel to the centered position and stop and the lock should engage.
- Manually press and hold the driver side cargo bay door switch to mimic a closed-door situation on the driver side. Press the driver side button on the remote. The slide should not be able to move to the driver side.
- Manually press and hold the passenger side cargo bay door switch to mimic a closed-door situation on the passenger side. Press the passenger side button on the remote. The slide should not be able to move to the passenger side.

## Changing Remote Code

The power slide RF Remote operates on a frequency of 418 MHZ. Each remote may be individually set to operate on a different code setting. The remote comes factory preset to a specific code.

To set a new remote to match the primary remote, remove the inspection cover on the back of the new remote. Adjust the dip switch in the new remote to match the code settings previously copied from the primary remote.

**If you have purchased a second remote you will need to change the code in the remote you purchased to match the code settings of your primary remote.**

**NOTE:** If you are creating a new code you will need to reprogram the Power Slide. Refer to **Figure 5** on Page 3 of the SuperSlide II PowerSlide Assembly Instructions.

First remove the inspection cover of the primary remote by prying it up at the recessed spots. Write down the remote settings in the diagram provided below.

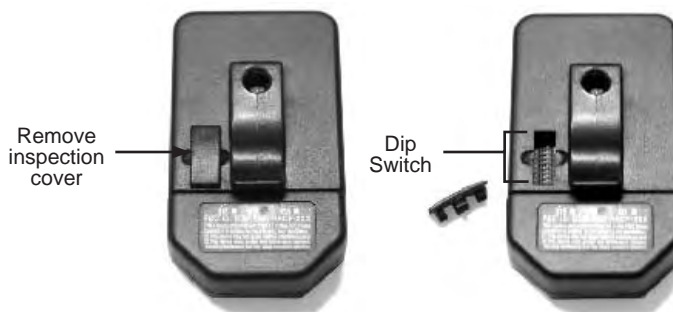

ON	ON	ON	ON	ON	ON	ON	ON	ON	ON
1	2	3	4	5	6	7	8	9	10