



REPLACEMENT INSTRUCTIONS

for Control Board Kit

Part # 3108701.339

To be used on Electronically Controlled Units Requiring 12V DC Power
Models Without Gas Heat — Follow Steps 1 & 2
Models With Gas Heat — No Modification Necessary

Kit consists of:

1 ea.	3105356.004	Control Board
1 ea.	3105165.025	Instruction Sheet
1 ea.	3104845.007	Bulletin A19/2A

Tools:

Small pair of wire side cutters

ONLY FOR MODELS WITHOUT GAS HEAT:

STEP 1:

Clip L.E.D. Lamp (Fig. A) and remove. Cut remaining wires as close to board as possible (Fig. B).

Fig. A



Fig. B

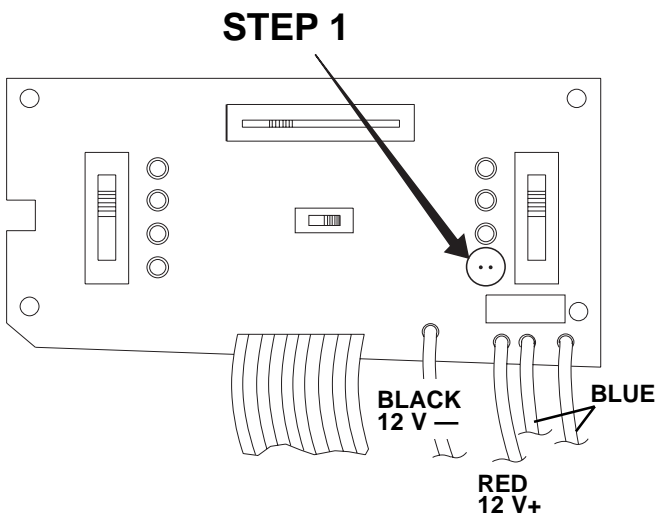

STEP 2:

Clip the two blue wires as close to board as possible and remove (Fig. C).

Fig. C

