

TO CLOSE AWNING:

① Return Awning to Travel Position

⚠ CAUTION

When awning is closed, bottom arm assembly will fold down and against back channel. To avoid personal injury and/or property damage, keep space beneath bottom arm assembly clear of objects and people.

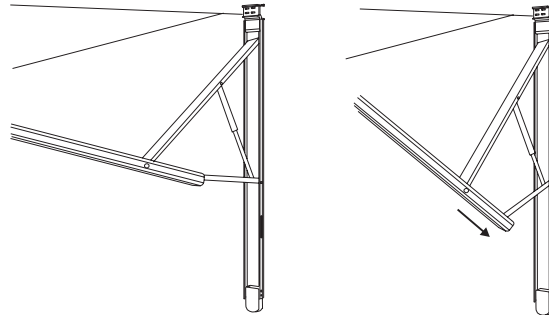

Press and hold the "RETRACT" button on the remote control, remote switch or control box. When awning is fully closed, release button.

Important: Do not press more than one "Retract" button at the same time. Awning will not work and/or may cause control box fuse to blow.

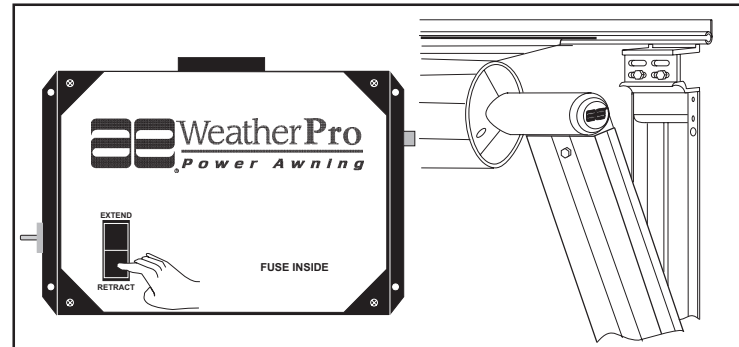

Important: As an extra safety precaution, visually verify that the awning is fully closed.

- A. If "RETRACT" button is released before the awning is fully closed, it will remain in the position when released. The awning will continue to close when pressed again.

IN CASE OF COACH POWER FAILURE:

1. The WeatherPro control box provides an auxiliary power connection in case of power failure in the coach. An external 12 VDC power source such as an automobile battery is required.
2. Locate the auxiliary power connection by the red and black wire with a two way plug and jack connector with a cap on it.
3. Remove the cap and connect the supplied 10 ft. harness by plugging in the connectors.

4. Attach the 10 ft. harness to the 12VDC source and the WeatherPro awning can be closed using the remote control, remote switch or control box.

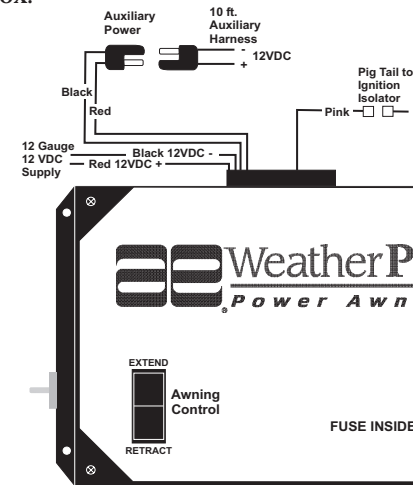

TO MANUALLY CLOSE AWNING:

Note: This procedure will require two people. When this procedure has been performed, the awning must be serviced by a Dometic Service Center or a qualified service technician before using again.

1. Slide the pull strap (provided) into the utility slot of the FRTA.
2. While one person is holding onto the pull strap, remove the bolt in the top of the right top casting. The FRTA will roll in once the bolt is removed. Walk the awning to the closed position.
3. Align hole where bolt was removed and drive bolt back into top casting to secure awning.

⚠ CAUTION

Bolt must be re-installed to prevent awning from opening during travel. Have awning serviced by a Dometic Service Center or a qualified service technician before attempting to open awning after this procedure has been performed.

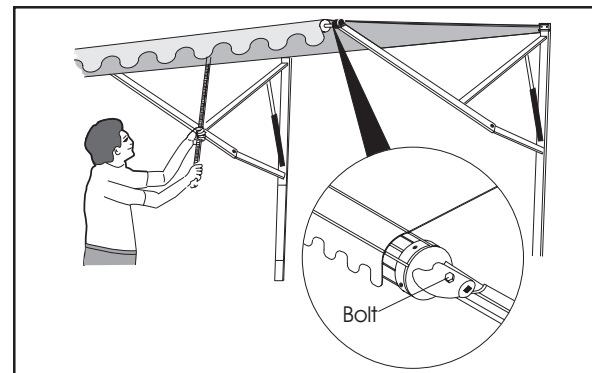

Form No. 3307823.009 6/02
(French 3307895.007)
©2002 Dometic Corporation
LaGrange, IN 46761

A&E WeatherPRO Patio Awnings



User's Guide

by Dometic Corporation

TO OPEN AWNING:

① Extend

Press and hold the "EXTEND" button on the remote control, remote switch or control box. When awning is fully open, release button.

Important: Do not press more than one "EXTEND" button at the same time. Awning will not work and/or may cause control box fuse to blow.

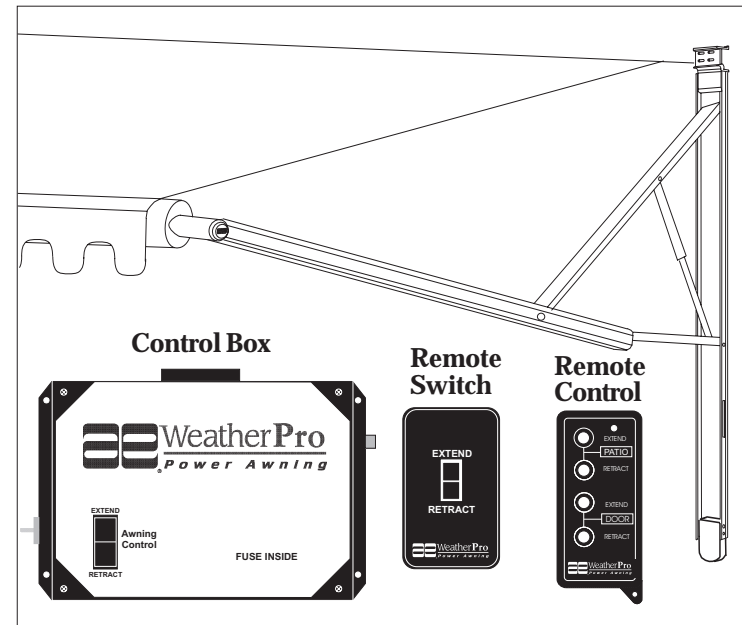

Note: The control box system is protected with a 10 amp fuse. If needed, a spare 10 amp fuse is taped inside the control box. Shut off the 12VDC power to control box and remove control box cover to expose fuse on inside. Replace if necessary.

A. If awning should hit an object while opening or button is not released at full open, the control box will cut power to the motor.

Important: When the power has been interrupted, wait approximately 30 seconds before depressing button again. The control box will automatically restore power when button is pressed again.

B. If "EXTEND" button is released before the awning is fully open, it will remain in the position when released. The awning will continue to open when pressed again.

Important: When installed correctly on a motorized RV, this system is wired to prevent accidental awning extension when vehicle ignition key is in the "ON" position. When ignition key is turned on, the power going to the awning will be interrupted and it will not operate in the "Extend" mode. This however, will not prevent awning from being retracted.

The A & E WeatherPro awning is equipped with a wind sensing device that will automatically close the awning when wind conditions are present that may damage the awning. To activate the wind sensing feature turn the wind sensor switch to the "ON" position. It is located on the left side of the control box. With switch in the "OFF" position awning will not be affected by high winds and will remain open and may cause damage to awning. The wind sensor switch is set to the "ON" position at the factory.

⚠ CAUTION

When the wind sensor switch is set to the "ON" position DO NOT hang items from the awning or tie the awning down. Damage to the awning and items may occur if the sensor is activated and the awning attempts to roll up.

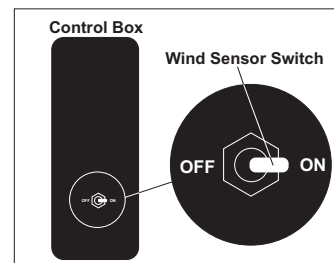

The WeatherPro Awning Control monitors the wind sensor switch position and wind speed events over the preset wind speed and stores it in memory. If wind sensor switch is in the "OFF" position and the wind exceeds the preset, the awning warranty may be voided if the awning is damaged by wind. **If Awning will not operate and the wind sensor switch is in the "ON" position, wind conditions may be above the preset wind speed which will not allow the awning to open.**

The wind sensor is specifically designed to allow air to pass through the carousel. If the sensing element in the wind sensor becomes wet the awning will not open if closed; or will automatically close if open. Normally the only way for it to get wet is by driving in rain or spraying water directly into the carousel. However, it is possible for it to get wet from severe angled rains or water condensing on the wind sensor. If you suspect this has occurred wait ten minutes for it to dry out before operating awning.

Important: The wind sensor will only function correctly if the airway to the sensing element is clear. Keep airway clear of dust, insects, ice, snow, or other debris. The sensing element can be cleaned with a small soft bristle brush.

The awning control box contains an audible alarm. When the alarm sounds the awning control has detected a problem either in the wind sensor or the wind sensor cable. If you hear a beeping sound coming from the control box when the sensor switch is in the "ON" position the wind sensor feature is not functioning. Turn the sensor switch off and contact a Dometic Service Center or a qualified service technician for assistance.

⚠ CAUTION

The A&E WeatherPro awning is extremely durable and can be operated during moderate rain and wind conditions. However, when periods of heavy rain and/or wind is expected the awning should be closed. Damage caused by wind and rain is not covered by warranty.

Rear Arm

Your A & E awning is designed to shed water if left out in the rain. The rear arm will automatically decrease the awning height approximately 9 inches when it is raining. When there is no longer the need to shed water it will return to the normal height.

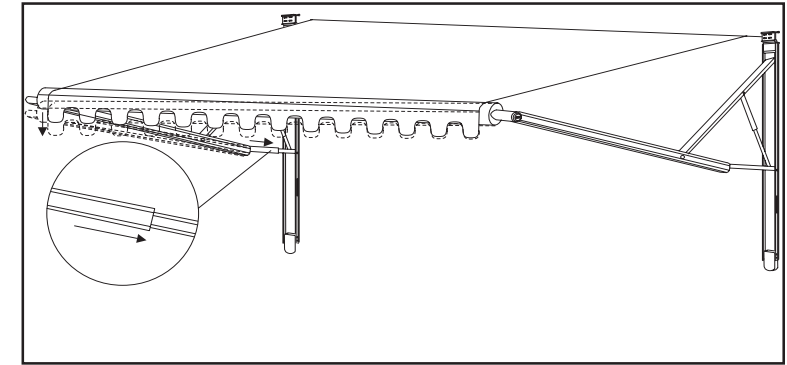

A&E WeatherPro HELPFUL HINTS:

- Whenever the awning is wet while rolled up, as soon as conditions allow, roll it out and let it dry before rolling it up again. This will help prevent the formation of mildew and add greatly to the life of the awning.
- Mildew does not form on the fabric itself, but on the accumulated dust, dirt and grime. Periodically clean vinyl or woven acrylic fabric using a mixture of 1/4 cup of dish soap and 1/4 cup of bleach mixed with 5 gallons of warm water. Liberally slosh the mixture on the top of the fabric and roll the awning up for 5 minutes. This will apply the mixture to the bottom as well. Roll it back out and hose off with fresh water. Repeat if necessary. Allow to dry before rolling up.
- Always make sure the awning is fully extended before opening the entry door.

WHEN TO GET MORE HELP:

This User's Guide is intended to provide practical instruction for the sequential operation of the A&E WeatherPro Patio Awning. If malfunctions occur that cannot be corrected by reviewing this Guide, contact a Dometic Service Center or a qualified service technician for assistance.