

### TYPICAL APPLICATIONS

Multi-fixture intermittent-duty potable water installations.  
 Other uses may include 12 VDC pressurized water systems. For other applications, contact SHURflo.  
 Use 254 series strainer with this pump.

### PUMP

Type	4 Chamber Diaphragm
Ports	Quick-Connect
Liquid	130 °F [54 °C] Max
Dry Prime	6 feet [1.8 M]
Inlet PSI	30 PSI [2.1 Bar] Max
Run Dry	Yes
Fittings	1/2"-14 NPSM Dual O-ring (2 included) 1/2", 3/4" Barb available (straight & elbow)

### Extreme™ Smart Sensor 4.0



### ELECTRICAL

Motor	12VDC Permanent Magnet, Intermittent Duty
Protection	Thermal Overload, Automatic Restart
Leads	16 AWG [1.3mm <sup>2</sup> ], 16" [40 cm] Red +, 13" [33 cm] Black -
Fuse	15 Amp Circuit Protection Required
Control	Microprocessor PWM Pressure Transducer
Shut-Off	Voltage Variant, Factory Set at 50 PSI [3.4 Bar] @ 12 VDC ± 5 PSI [.4 Bar]

### MATERIALS

Housing	Nylon
Valves	EPDM
Diaphragm	Santoprene
Hardware	Stainless Steel

### APPROVALS

CSA, CE, e, C-Tick [pending]

### LIMITED WARRANTY

3 Year Limited Warranty  
 See SB-1041 & MS-030-123 For Details

### SHIPPING

Net Weight (Boxed)	6 Lb [2.7 Kg] each
Carton Weight	6 each, 37 Lb [16.8 Kg]
Carton Size	25"L x 20"W x 7"H [64cm x 51cm x 18cm]

### RELATED DOCUMENTS

Catalog	MS-030-083
Installation Manual	911-696
Maintenance	911-696
Applications Spec Guide	MS-020-005
Warranty	SB-1041/MS-030-123

### Parts Kits

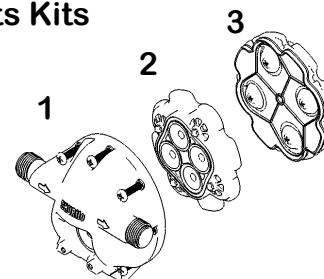

#	Components	Parts Kits
1	Upper Housing	94-670-01
2	Valve Assembly	94-669-00
3	Drive Assembly	94-670-00

**Typical Performance**

PRESSURE		FLOW		CURRENT
BAR	PSI	GPM	LPM	AMPS
0.0	0	4.0	15.1	4.0
0.7	10	3.1	11.7	6.5
1.4	20	2.8	10.5	7.5
2.1	30	2.5	9.4	8.5
2.8	40	1.3	4.9	6.8
3.4	50	0	0	0

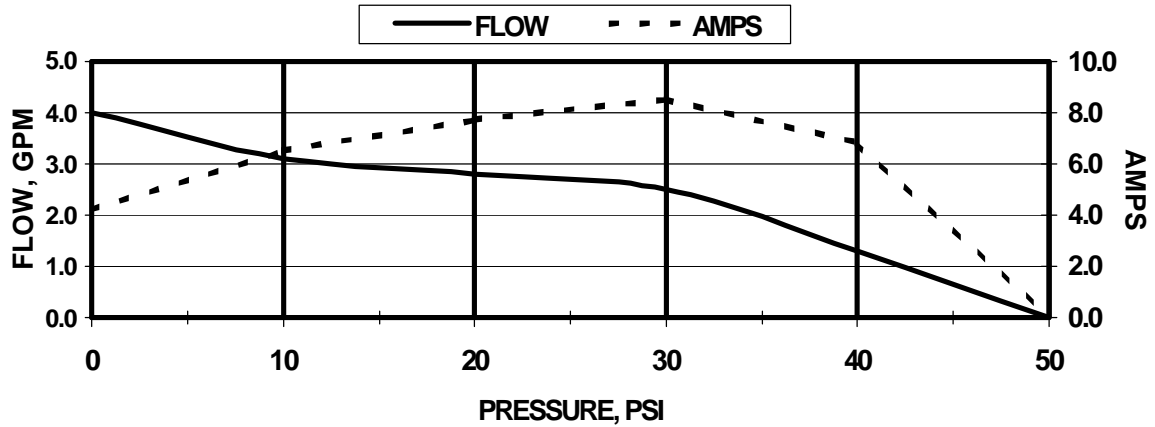

Actual flows will vary depending on system configurations

**Typical Dimensions (no fittings)**
