

Correction of Over-Performance on Models 322/323

The LP gas control of the refrigerator uses an adjustable gas control valve [1] and requires input pressure at 11 inches water column (See Art01077) .

The gas control is used for gas ignition and to change the amount of LP gas that goes to the burner.

The gas control acts as the temperature control of the refrigerator.

The gas control is not automatic. It does not automatically change the flame from high fire to low fire.

When the refrigerator load changes, the gas control requires manual adjustments to maintain the temperature inside the refrigerator.

When the outside ambient temperature is 50° F or lower, the unit may have a tendency to over cool (freeze food). To reduce the tendency to freeze food:

- Turn the gas control [1] counter clockwise past the LOW COOL position as far as it will go.
- Keep the refrigerator full.
- Put foods that are more likely to freeze on the top or middle shelves.

If over cool continues, replace the by-pass screw of the gas control (Part Number 620654). To replace (See Art01077):

NOTE: To obtain replacement by-pass screw, contact Norcold at 1-800-543-1219.

- Remove existing by-pass screw [2] and replace with new by-pass screw provided by Norcold.
- Adjust gas control to maintain the desired temperature inside the refrigerator.

At low ambient temperatures, block the lower outside vent with a noncombustible material to decrease the flow of input air. When blocking the vent, make sure that the lowest louver is open. The lowest louver must remain open.

Turn the refrigerator OFF during the evening hours or when the outside ambient temperature is 32° F or lower.

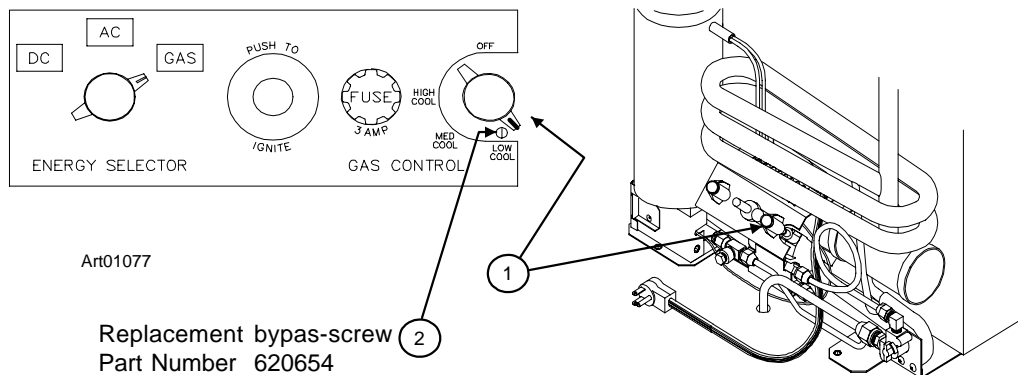

NOTE: If you have done all of the items that are recommended in the instructions above and the problem of over performance continues, please contact Norcold Customer Service by telephoning (800) 543-1219.