

When ordering parts, always state:
MODEL NO. - PRODUCT NO. - QUANTITY -
PART NUMBER - DESCRIPTION
For Electric Details also state:
VOLTAGE - WATTAGE



USA
SERVICE OFFICE
Dometic Corporation
2320 Industrial Parkway
Elkhart, IN 46516
574-294-2511

CANADA
Dometic Corporation
46 Zatonski, Unit 3
Brantford, ON N3T 5L8
CANADA
519-720-9578

For Service Center
Assistance Call:
800-544-4881

WeatherPro Hardware Model

8551(X)01.400(X) Basement

8551(X)02.400(X) Standard

8551(X)03.400(X) 5th Wheel Basement

8551(X)04.400(X) 5th Wheel Standard

PARTS LIST

MODEL

| | |
|----------------|----------------|
| 8551101.400(X) | 8551201.400(X) |
| 8551102.400(X) | 8551202.400(X) |
| 8551103.400(X) | 8551203.400(X) |
| 8551104.400(X) | 8551204.400(X) |

Hardware

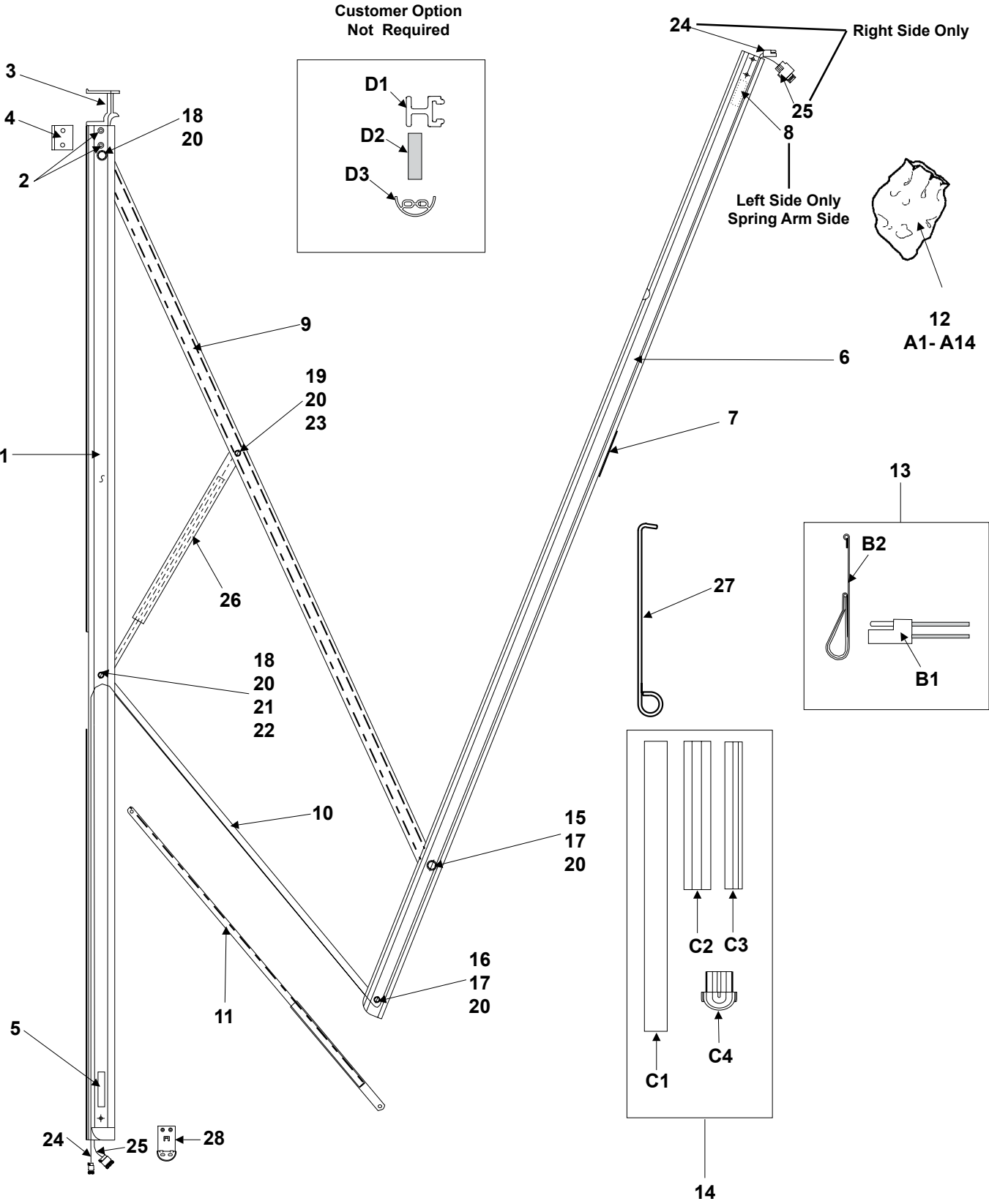

| Item No. | Part No. | 8551101.400(X) 8551102.400(X) 8551103.400(X) 8551104.400(X) 8551201.400(X) 8551202.400(X) 8551203.400(X) 8551204.400(X) | | | | | | | | Description |
|----------|---------------------|---|---|---|---|---|---|---|---|--|
| | | A | B | C | D | E | F | G | H | |
| 1 | ----- | A | B | C | D | E | F | G | H | Back Channel (2 req.) See Note 1. |
| 2 | 3307879.003 | A | B | C | D | E | F | G | H | Screw, 10-12 x .38" # 2 Torx BH Silver (8 req.) |
| 3 | *3310331.000(X) | A | B | - | - | E | F | - | - | Bracket, Top Mounting, Standard/Basement (2 req.) |
| | *3310332.000(X) | - | - | C | D | - | - | G | H | Bracket, Top Mounting, 5th Wheel Standard/Basement (2 req.) |
| 4 | *3307608.004(X) | - | - | C | D | - | - | G | H | Bracket, Side Mounting, 5th Wheel Standard/Basement (4 req.) |
| 5 | 3109661.011 | A | B | C | D | E | F | G | H | Decal, Pinch Point (2 req.) |
| 6 | ----- | A | B | C | D | E | F | G | H | Front Channel (2 req.) See Note 1. |
| 7 | 3307846.000 | A | B | C | D | E | F | G | G | Decal, WeatherPro |
| 8 | 3109714.018 | A | B | C | D | E | F | G | H | Decal, Rapid Casting Spin Off |
| 9 | *3307681.001(X) | A | - | C | - | E | - | G | - | Arm Asm., Top |
| 10 | *3307689.004(X) | - | B | - | D | - | F | - | H | Arm Asm., Top |
| | *3307745.004(X) | A | - | C | - | E | - | G | - | Arm Asm., Bottom RH |
| 11 | *3307745.012(X) | - | B | - | D | - | F | - | H | Arm Asm., Bottom RH |
| | *3310384.100(X) | A | - | C | - | E | - | G | - | Kit, Spring Arm Asm., Bottom LH |
| 12 | *3310384.200(X) | - | B | - | D | - | F | - | G | Kit, Spring Arm Asm., Bottom LH |
| | *3108391.107(X) | A | B | - | - | E | F | - | - | Kit, Hardware |
| 12 | *3108391.115(X) | - | - | C | D | - | - | G | H | Kit, Hardware |
| | A1 3104499.094 | A | B | - | - | E | F | - | - | Screw, #14-10 x 2.75" Blk. (4 req.) |
| | A2 3104499.003 | - | - | C | D | - | - | G | H | Screw, S 14-10 x 1.50" HHW SS (4 req.) |
| | A3 3104499.086 | A | B | C | D | E | F | G | H | Screw, #14-10 x 2" Blk. (4 req.) |
| | A4 310359.013 | A | B | C | D | E | F | G | H | Screw, #10-16 x .75" Blk.(4 req.) |
| | A5 *3108404.009(X) | A | B | - | - | E | F | - | - | Cover, Screw (2 req.) |
| | A6 310359.012 | A | B | C | D | E | F | G | H | Screw, #6-20 x .44" (2 req.) |
| | A7 3104176.205 | A | B | C | D | E | F | G | H | Screw, Hex 1/4"-20 x .75" (2 req.) |
| | A8 3101746.000 | A | B | C | D | E | F | G | H | Washer, Split Lock .25 (2 req.) |
| | A9 113008P | A | B | C | D | E | F | G | H | Rivet, Oscar 3/16" x 1" (4 req.) |
| | A10 *3109752.000(X) | A | B | C | D | E | F | G | H | Cover asm., Bottom Brkt. (2 req.) |
| | D1 3109298.012 | A | B | C | D | E | F | G | H | Decal |
| | A11 *3307943.005(X) | A | B | C | D | E | F | G | H | Spacer (2 req.) |
| | A12 3104176.213 | A | B | C | D | E | F | G | H | Screw, Hex Cap 1/4"-20 x 1.25 SS |
| | A13 317534.006 | A | B | C | D | E | F | G | H | Nut, lock W/Insert 1/4"-20 SS |
| | A14 309513.045 | A | B | C | D | E | F | G | H | Washer, Nylon |
| 13 | 3109987.002 | A | B | C | D | E | F | G | H | Kit, Auxillary Operational |
| | B1 3109609.002 | A | B | C | D | E | F | G | H | Harness, Control Box, Two Wire, L = 10' |
| | B2 3109799.051 | A | B | C | D | E | F | G | H | Strap Asm., Pull |
| 14 | *3309719.007(X) | A | - | C | - | E | - | G | - | Wire Cover Assembly, Basement |
| | *3309719.019(X) | - | B | - | D | - | F | - | H | Wire Cover Assembly, Standard |
| | C1 *3309428.013(X) | A | - | C | - | E | - | G | - | Wire Cover, Front Channel, Basement, L = 53.50" |
| | *3309428.005(X) | - | B | - | D | - | F | - | H | Wire Cover, Front Channel, Standard, L = 58.00" |
| | C2 *3309429.011(X) | A | - | C | - | E | - | G | - | Wire Cover, Back Channel, Basement, L = 21" |
| | *3309429.003(X) | - | B | - | D | - | F | - | H | Wire Cover, Back Channel, Standard, L = 27" |
| | C3 *3309427.015(X) | A | - | C | - | E | - | G | - | Wire Cover, Bottom Arm, Basement, L = 20" |
| | *3309427.007(X) | - | B | - | D | - | F | - | H | Wire Cover, Bottom Arm, Standard, L = 25" |
| | C4 *3307803.001(X) | A | B | C | D | E | F | G | H | Cover, Front Channel (2 req.) |

*Replace (X) With Color Code From Color Code Chart Below

| Color Code Chart | |
|------------------|---------------------|
| B | = Polar White |
| H | = Mende Polar White |
| R | = Champagne |
| S | = Satin |
| U | = Black |
| V | = Gold |

Note 1- Front And Back Channels are not available as separate items. Order complete hardware sets.

| Item No. | Part No. | A | B | C | D | E | F | G | H | Description |
|----------|-----------------|----------------|----------------|----------------|----------------|----------------|----------------|----------------|----------------|---|
| | | 8551101.400(X) | 8551102.400(X) | 8551103.400(X) | 8551104.400(X) | 8551201.400(X) | 8551202.400(X) | 8551203.400(X) | 8551204.400(X) | |
| 15 | 3308202.005 | A | B | C | D | E | F | G | H | Washer, Nylon .540" OD/.405 ID (4 req.) |
| 16 | 3307762.116 | A | B | C | D | E | F | G | H | Bushing, Split (4 req.) |
| 17 | 3307737.001 | A | B | C | D | E | F | G | H | Pin, .375" x 2.93" (4 req.) |
| 18 | 3307737.019 | A | B | C | D | E | F | G | H | Pin, .375" x 2.68" (4 req.) |
| 19 | 3307737.027 | A | B | C | D | E | F | G | H | Pin, .375" x 2.50" (2 req.) |
| 20 | 3307738.017 | A | B | C | D | E | F | G | H | Ring, Ext Self-Lock SS (10 req.) |
| 21 | 3307762.124 | A | B | C | D | E | F | G | H | Bushing, Split (4 req.) |
| 22 | 3307762.132 | A | B | C | D | E | F | G | H | Bushing, Split (4 req.) |
| 23 | 3307762.140 | A | B | C | D | E | F | G | H | Bushing, Split (4 req.) |
| 24 | 3109702.021 | A | - | C | - | E | - | G | - | Harness, Gear Motor, Basement, L = 115" |
| | 3109702.039 | - | B | - | D | - | F | - | H | Harness, Gear Motor, Standard, L = 127" |
| 25 | 3309368.011 | A | - | C | - | E | - | G | - | Harness, Sensor, Basement, L = 117" |
| | 3309368.029 | - | B | - | D | - | F | - | H | Harness, Sensor, Standard, L = 129" |
| 26 | 3310555.000 | A | - | C | - | E | - | G | - | Strut, Gas, Basement (2 req.) |
| | 3108392.139 | - | B | - | D | - | F | - | H | Strut, Gas, Standard (2 req.) |
| 27 | 3104926.013 | A | B | C | D | E | F | G | H | Pull Rod |
| 28 | *3109141.006(X) | A | B | C | E | E | F | G | H | Bracket, Bottom |

Customer Option-Not Required

| | |
|----------------|---------------------------|
| 3108710.199 | Kit, Stand Off Bracket |
| D1 3109730.006 | Standoff, Top (2 req.) |
| D2 3108708.094 | Pad (6 req.) |
| D3 3109506.109 | Standoff, Bottom (2 req.) |