

# Look at American Technology... See the Difference.

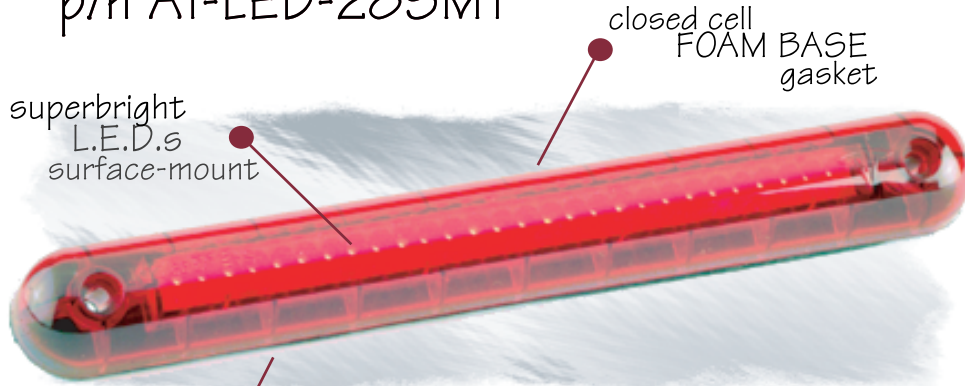

## CENTER HIGH MOUNT STOP LAMP

p/n AT-LED-28SMT



Low profile surface mount

side view

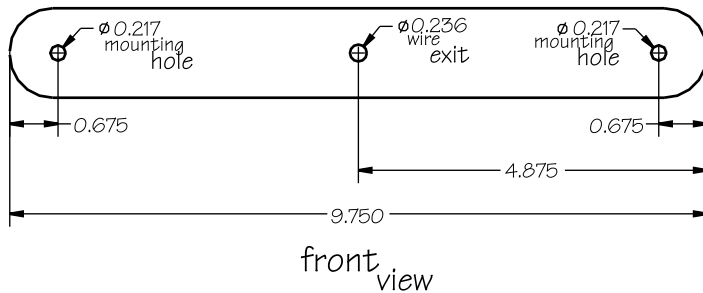
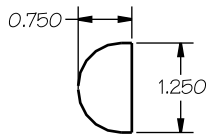

This surface-mount low profile L.E.D. lamp can be used for multiple applications, including commercial utility toppers, cargo trailers, recreational trailers and vehicles - and more!

Lamp features include:

- .750" Low profile surface mount lamp, no mounting hole required.
- Superbright L.E.D.s exceed S.A.E. requirements.
- Sealed lamp design and construction. Closed cell foam base gasket.
- Dual mounting holes for positive installation.
- Amp pins pre terminated on wire leads for locking Amp connectors.

CALL US TODAY  
WITH YOUR APPLICATION!

e-mail [sales@atcomp.com](mailto:sales@atcomp.com)

Call us or visit our website today!  
[www.atcomp.com](http://www.atcomp.com)  
1.800.238.2687

## SPECIFICATIONS

voltage  
amperage (typical)  
ratings & approvals  
material

13.8v dc nominal (9 - 15v dc)  
.181amps @ 13.8v dc  
s.a.e. u 99  
high impact polycarbonate lens



**American Technology**  
COMPONENTS, INCORPORATED

Look at American Technology... see the difference.

2905 LaVanture Place • Elkhart, Indiana 46514 USA  
574.262.1258 • FAX 574.264.9138